



AACPL Riviera Beach Library

COMMUNITY MEETING
12 DECEMBER 2017



G+P Library Experience

- **G+P designing libraries since 1990**
- **Extensive library design & programming experience**
 - Crofton, Perryville, Miller, Glenwood, Prince Frederick, East Columbia, Leonardtown, Rockville, Frostburg, Hopewell, Burke, Sterling, Wheaton, Quince Orchard, Savage
- **Community Architects**
 - Libraries, schools, colleges, recreation centers, senior projects, public safety, mixed use & multi-family
- **Experts in Sustainable Design + LEED**
- **Award Winning Designs**
- **On-time, On-Budget Track Record**



G+P has worked on more than 30 public library projects and developed more than 20 library programs



Project Schedule

1. Programming – In progress
2. Schematic Design – Complete by Summer 2018
3. Design Development – Complete by Winter 2018
4. Construction Documents – Complete by Summer 2019
5. Bid – Fall 2019
6. Construction – Fall 2019 through Spring 2021



Vicinity Map

Legend

- ▣ Justice Refugee Center
- ▣ House 1
- ▣ Five Buoys
- ▣ Riviera Beach Community Library - Anne Arundel County Public Library

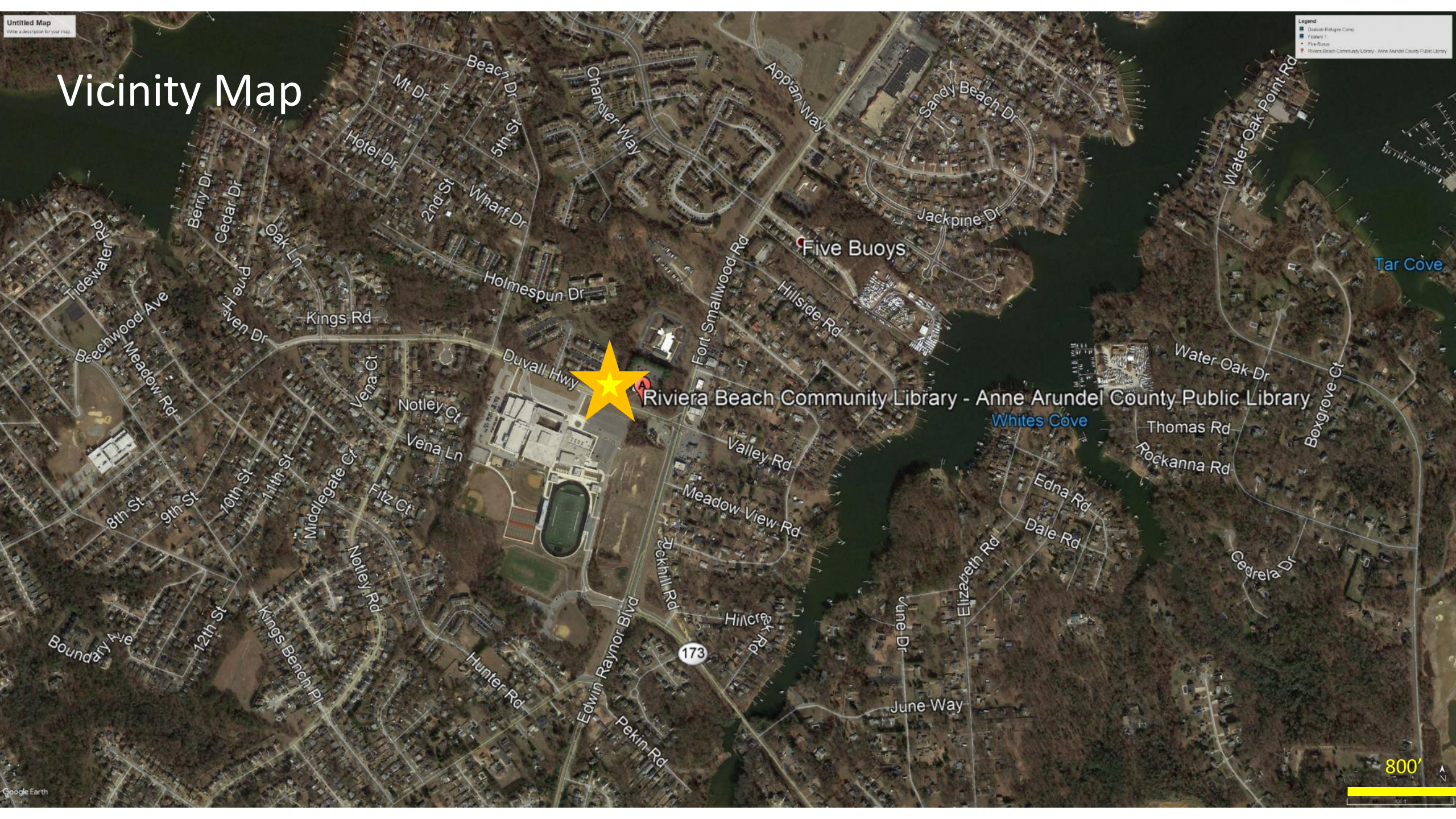

Riviera Beach Community Library - Anne Arundel County Public Library

800'

Community
United Methodist
Church

Existing Library

Duval Hwy

Fort Smallwood Rd.



Community
United Methodist
Church

Existing Library

Fort Smallwood Rd.

Duvall Hwy



Duvall Hwy

Fort Smallwood Rd.

173

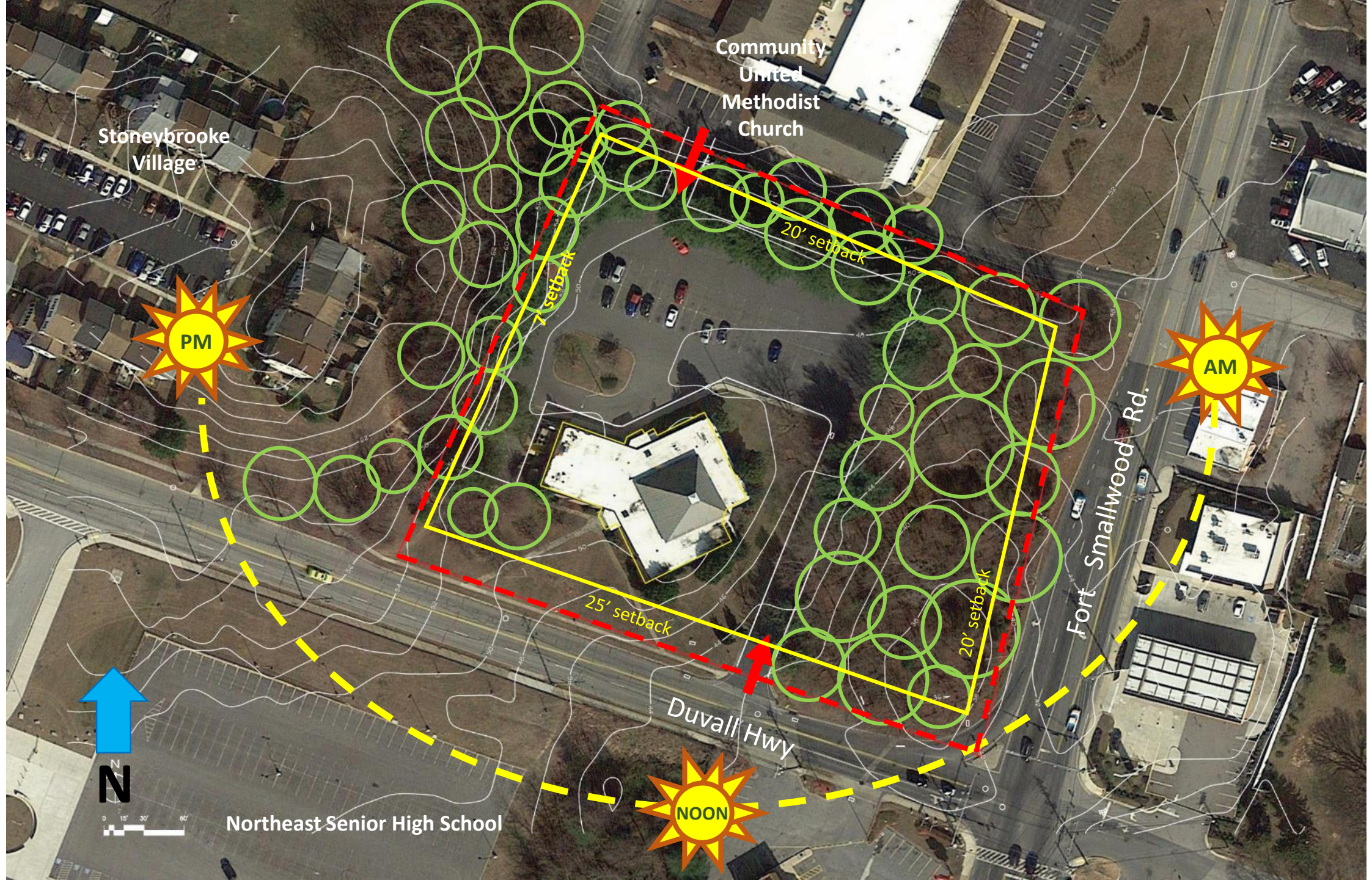

Zoning Requirements

Zoning is R5 so principal structure set-backs/height restriction are:

- Front lot line = 25 ft
- Rear lot line = 20 ft
- Side lot line = 7 ft
- Side corner lot line = 20'
- Maximum height = 35'

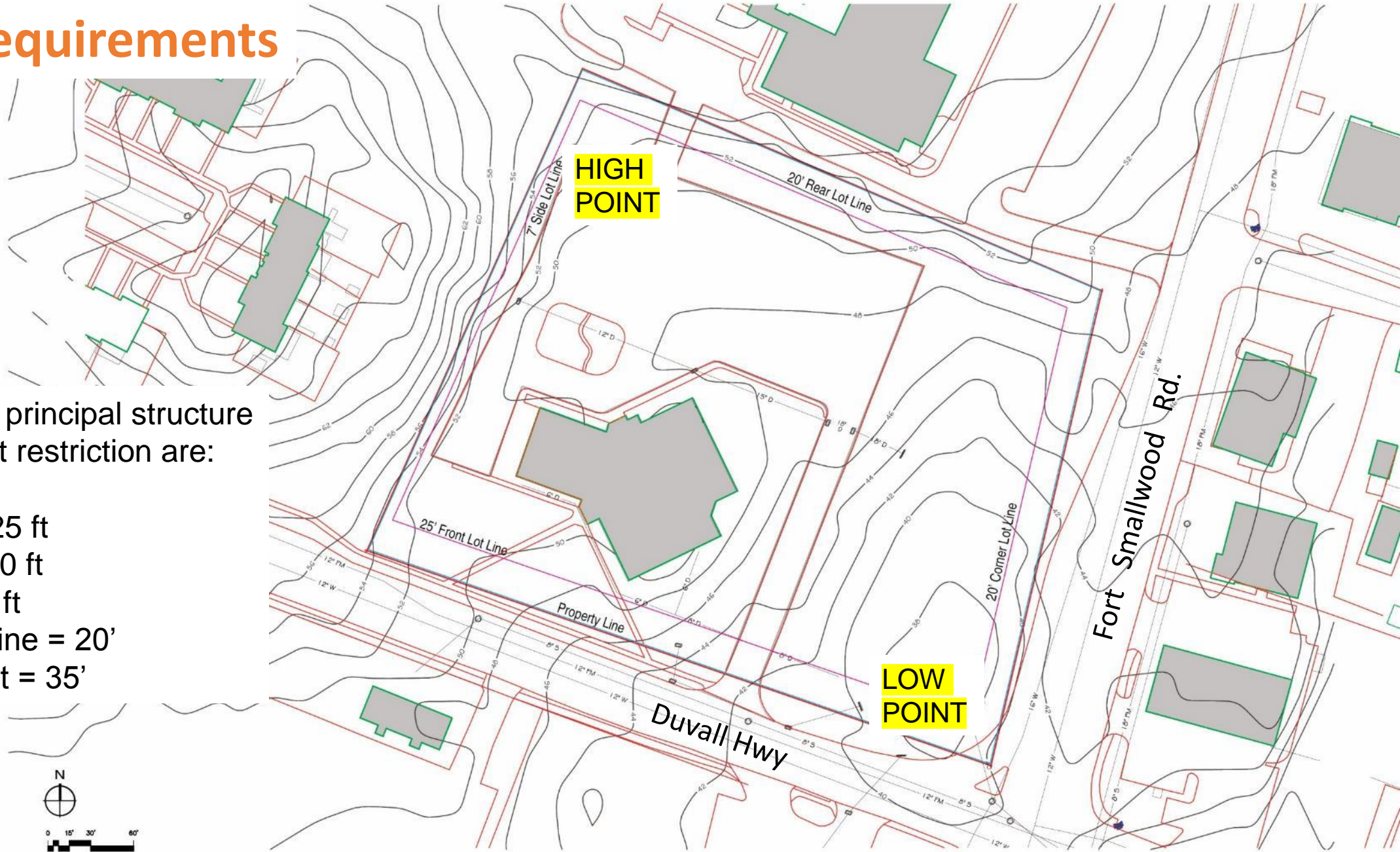

Riviera Beach Library





Duvall Hwy

Fort Smallwood Rd.

Riviera Beach Library – EXISTING CONDITIONS

Riviera Beach Community + Context



Community Inspired Design



Open + Inviting



Study + Collaboration Rooms



STEM Library (Branch Focus)





DISCOVER

IMAGINATION

ADVENTURE









Program: List of Spaces

What kinds of spaces will enhance the library experience for the customers?

What kinds of spaces will enhance the library experience for the staff?

	Description
	Public Areas:
	Airlock Vestibule
	Lobby + Display
	Café Vending + Seating
	Large Meeting Room + Storage
	Storage for Children's Programs
	Mtg Rm Kitchenette
	Mtg Rm Storage - tables and chairs
	Library Restrooms
	Janitor's Closet
	Sub-total Net Sq. Ft.:
Main Adult Areas	
Self Check out	
Customer Service Desk	
Reserves / Holds	
Study / Tutoring Rooms	
Laptop (Power) Bar Near Café	
Maker Space Lab & Resource Room	
Copier	
New Items + Display	
Fiction	
Non-Fiction	
A/V	
Periodicals	
Lounge Seating	
Tables and Chairs	
Computer PAC	
Sub-total Net Sq. Ft.:	
	Description
	Children's Areas
	Child Open Floor Area for Young Children
	Family Restroom
	Children's Computers
	Study / Tutoring Room
	Children's Collection
	Tables and Chairs
	Lounge Seating
	Sub-total Net Sq. Ft.:

	Description
	Teen Areas
	Teen Computers
	Project / Study rooms
	STEM Lab
	Teen Collection
	Lounge Seating
Table and Chairs	
Sub-total Net Sq. Ft.:	
	Description
	Staff Areas
	Book Cart Area
	Open Area Work Room
	Library Staff Work Stations
	Branch Manager office
	Children's Librarian
	Staff Flex Office
	Book return
	Delivery (with airlock)
	Library Storage
	Office Supplies
	Staff restrooms
	Staff Lockers
	Staff Breakroom (Kitchen + Seating)
	Server Room
Sub-total Net Sq. Ft.:	
	Description
	Support Areas (shared):
	Mechanical Room
	Sprinkler / Fire Pump Room
	Electrical Room for Building
	Building Telecomm Room / Data
	Building Maintenance and Storage
Sub-total Net Sq. Ft.:	

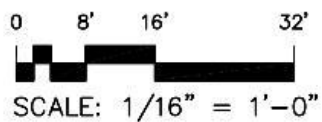
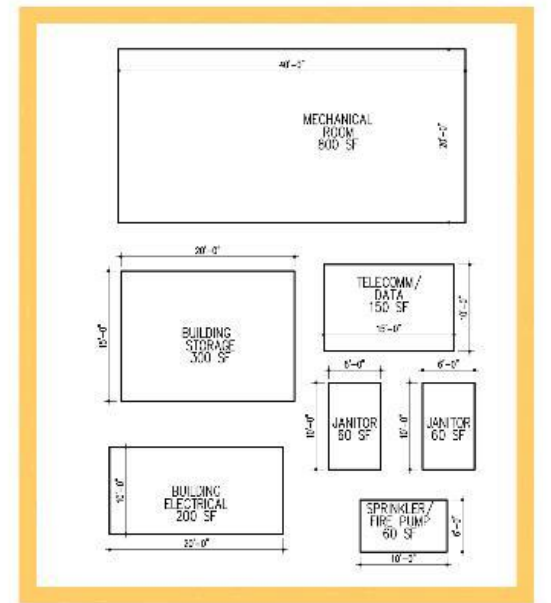
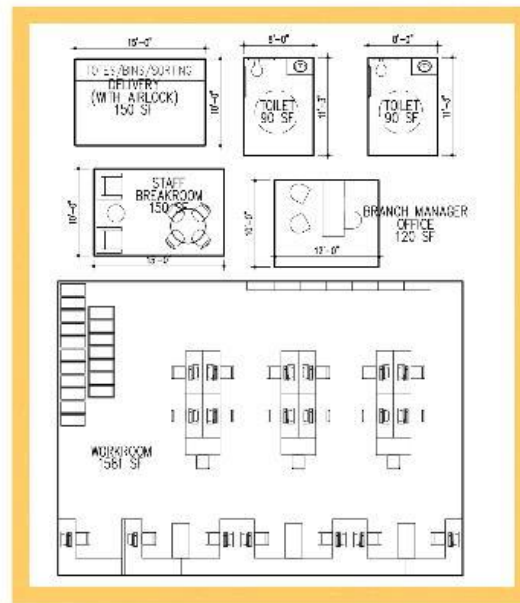
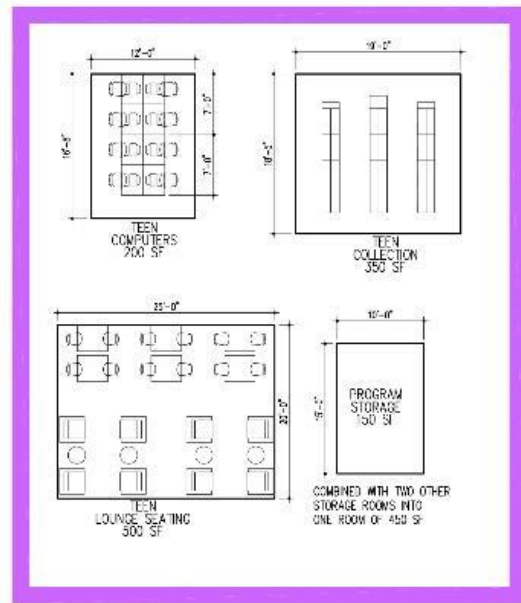
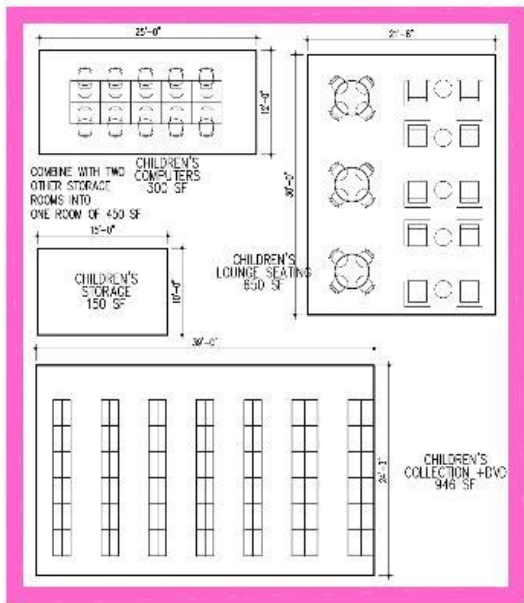
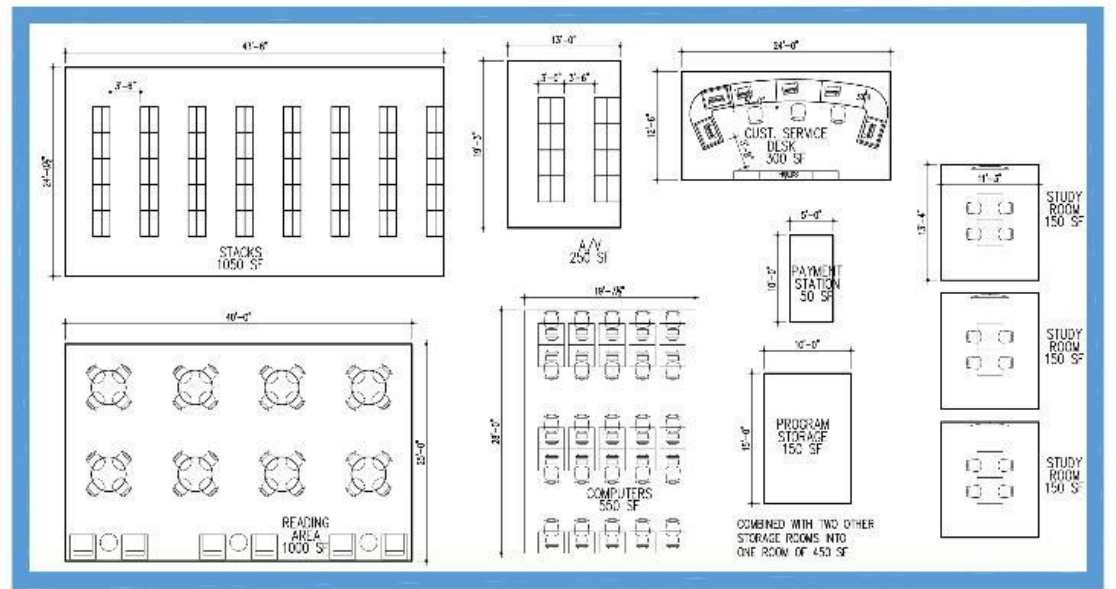
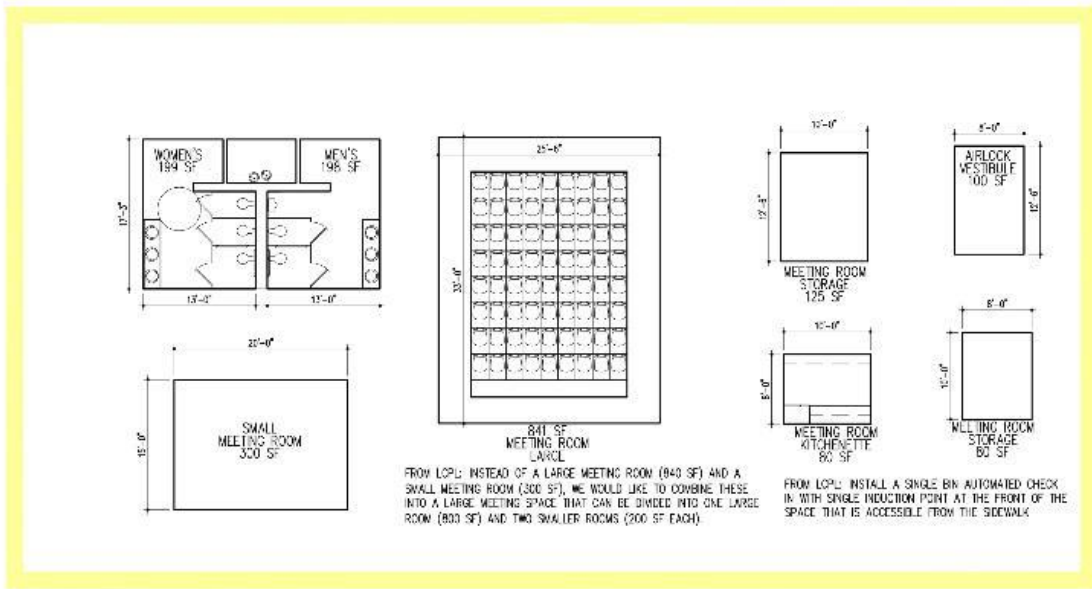

SPACE DIAGRAMS EXAMPLE

We want to hear from you!

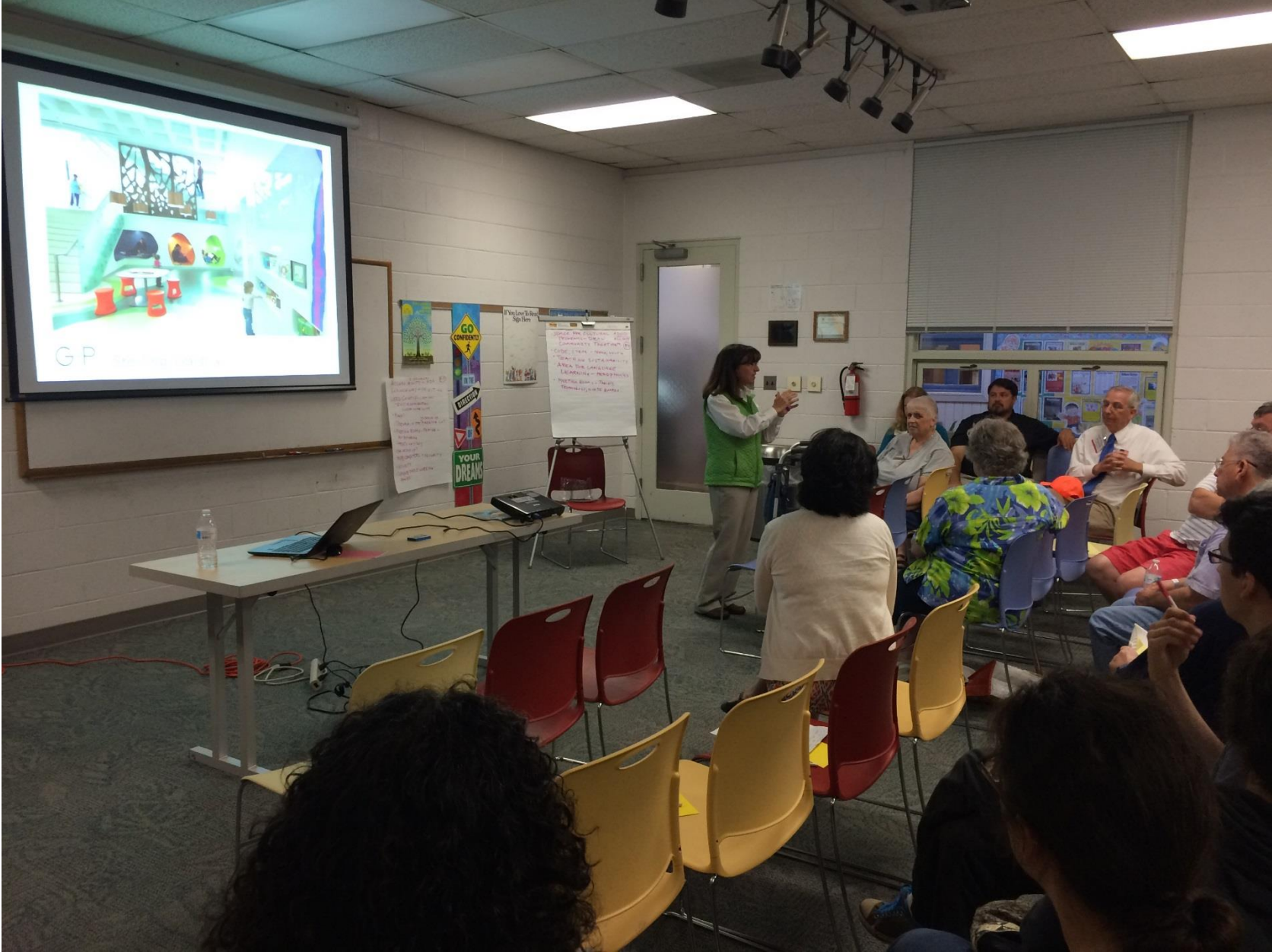

1. How many times have you visited the Riviera Beach Community Library?

- A. Occasionally
- B. Weekly
- C. Monthly
- D. More than I can count
- E. I have not visited in the past year.

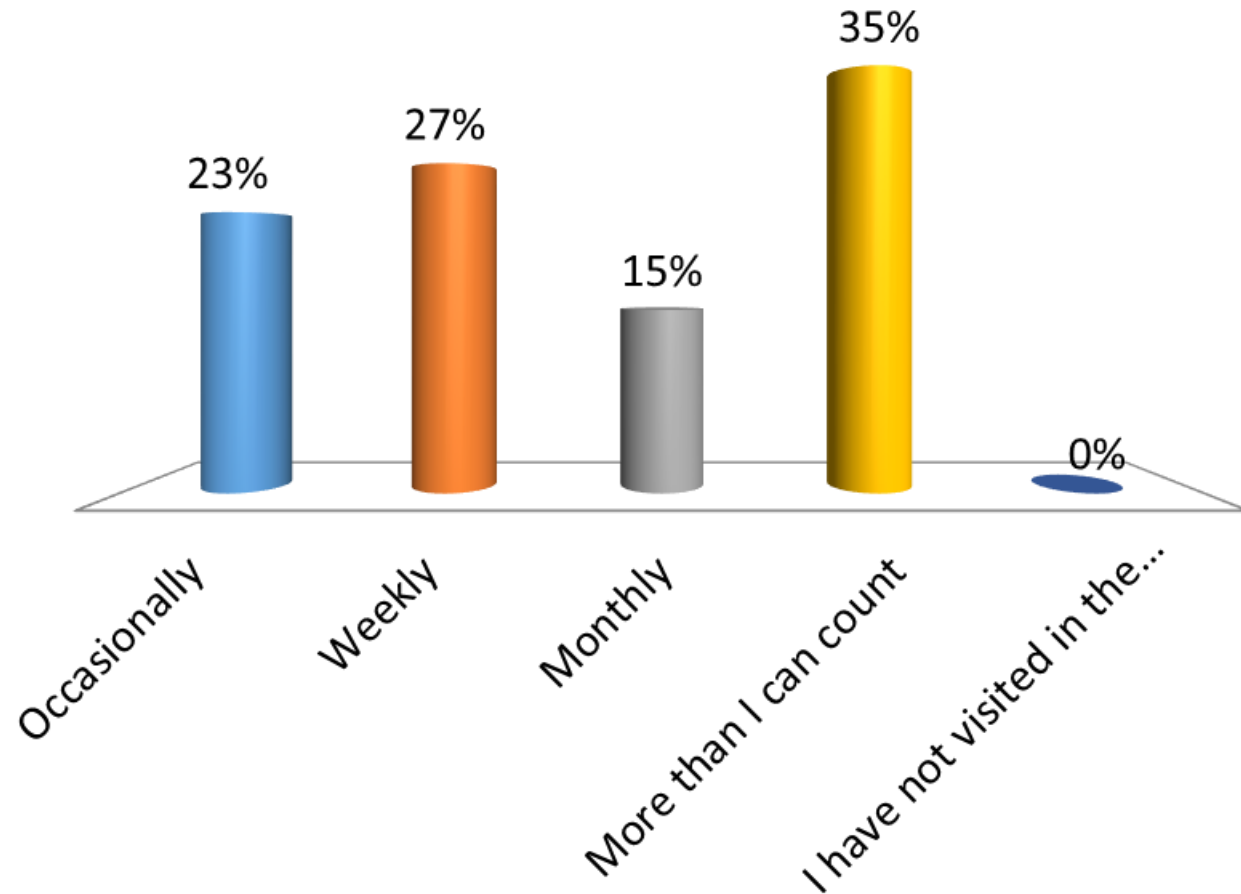

2. I typically visit the library with...

- A. (My) kids
- B. A friend
- C. An adult
- D. By myself
- E. I don't visit the library

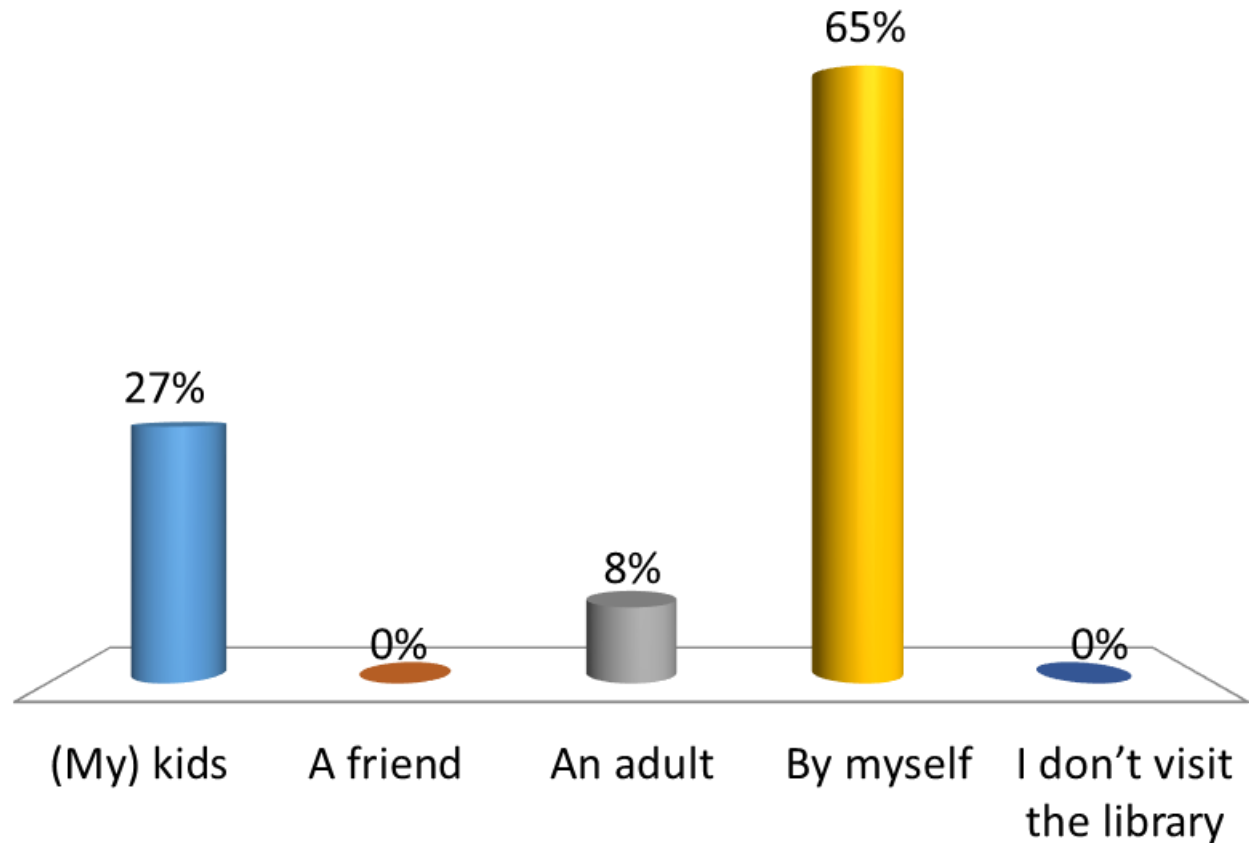

3. I am...

- A. A parent of children under the age of 5
- B. Under 13 years old
- C. 14-17 years old
- D. 18-25 years old
- E. 26-39 years old
- F. 40-60 years old
- G. 61 years or older

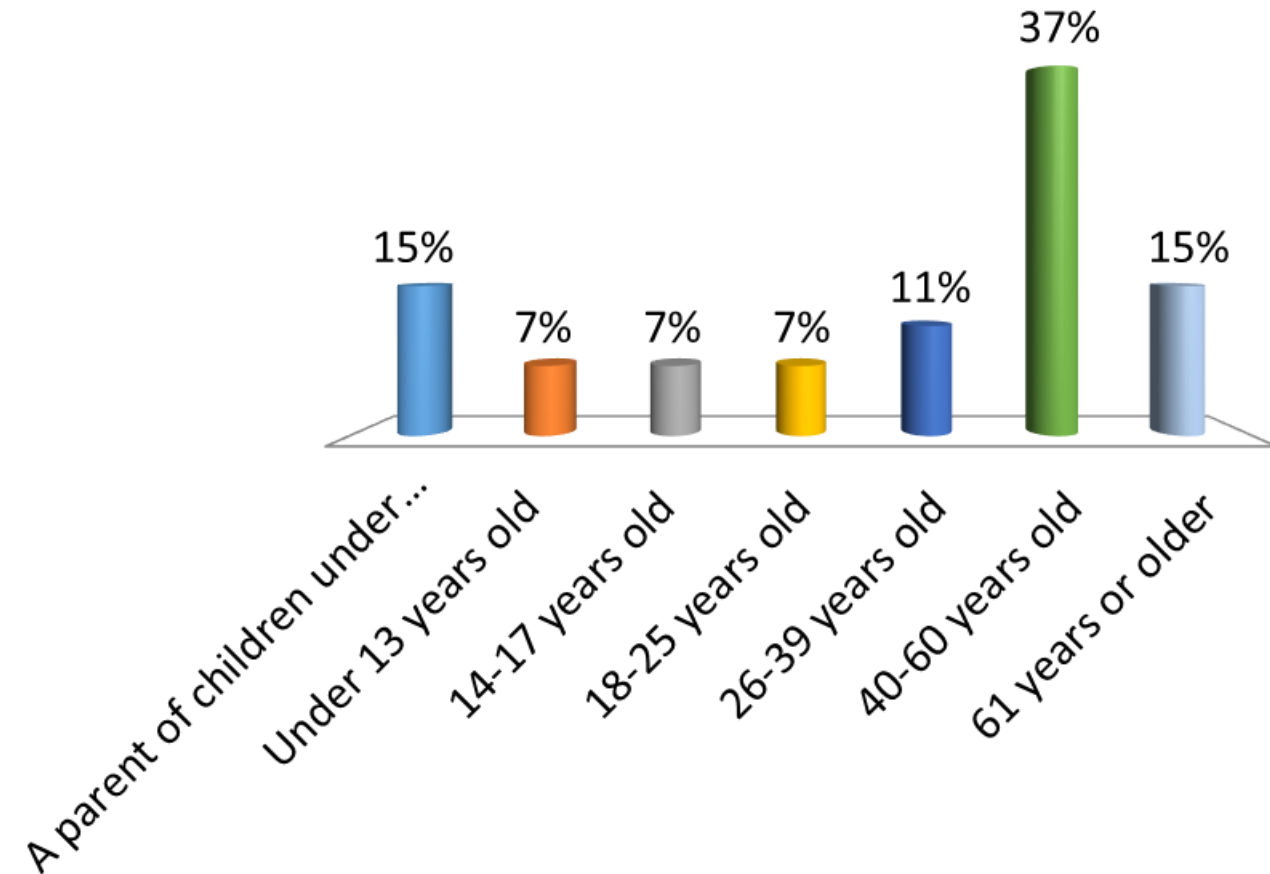

4. How long have you been a part of the Riviera Beach Community?

- A. 1-5 years
- B. 6-10 years
- C. 11-20 years
- D. My entire life
- E. I do not live in the community

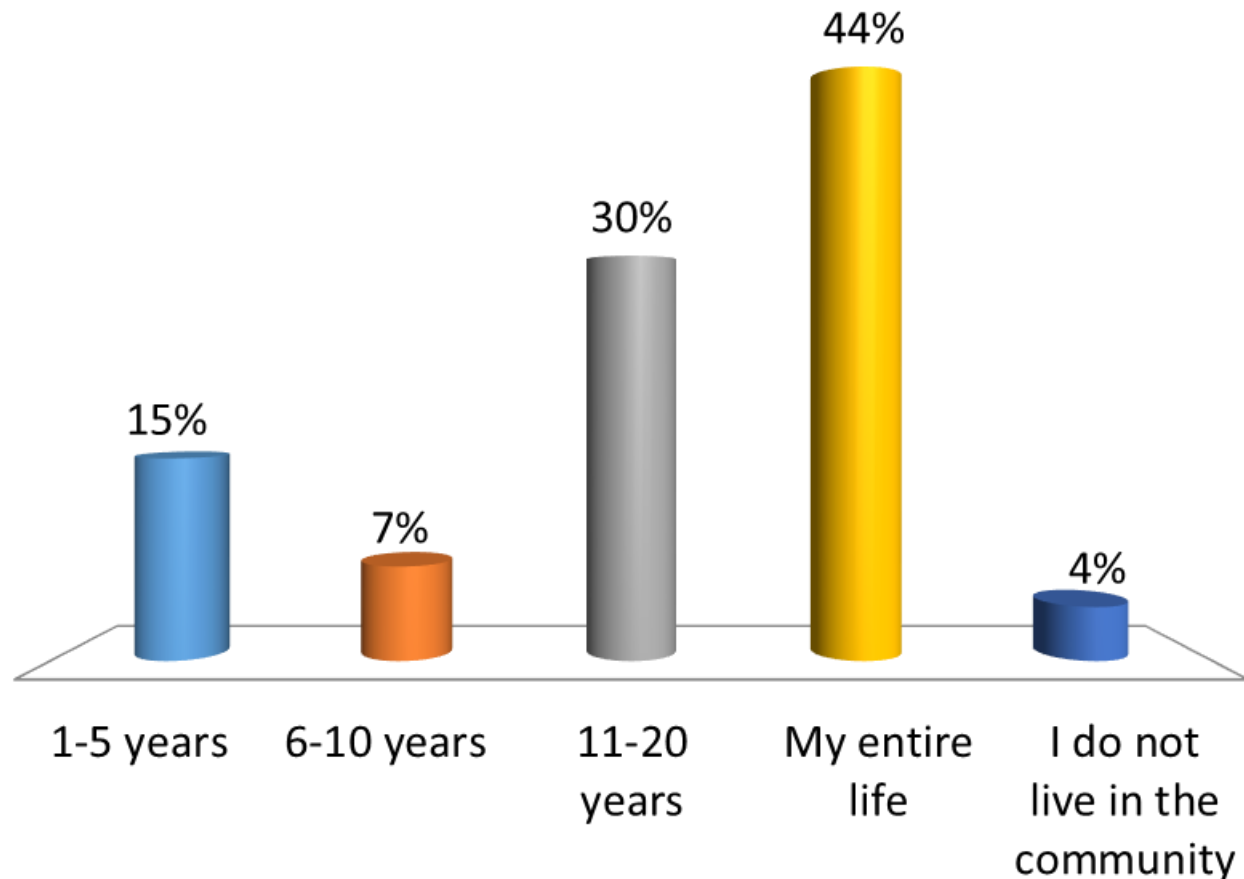

5. How do you typically travel to the Library?

- A. Walk
- B. Bicycle
- C. Bus
- D. Drive

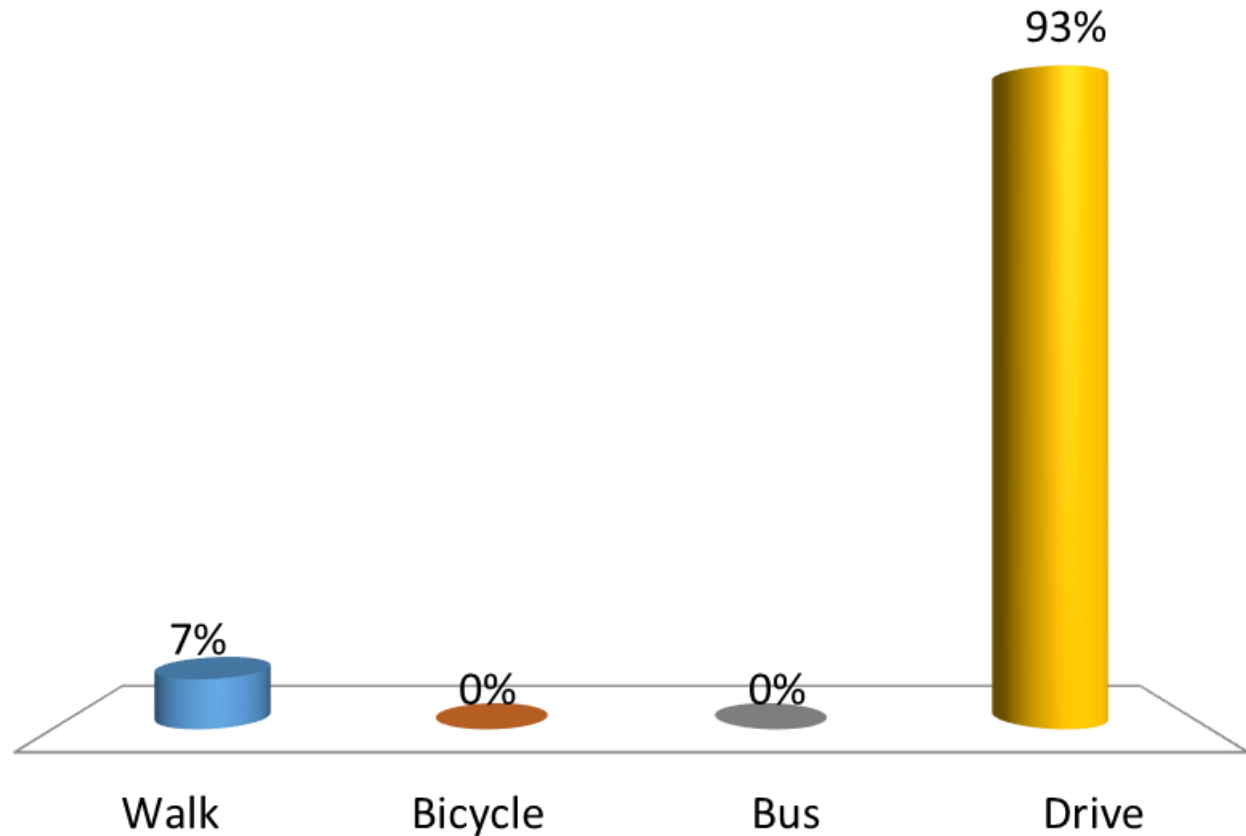

6. Have you used the following services at the library?

- A. Books/DVDs/Other Media
- B. WiFi/Computers/Online services
- C. Both
- D. None of these services

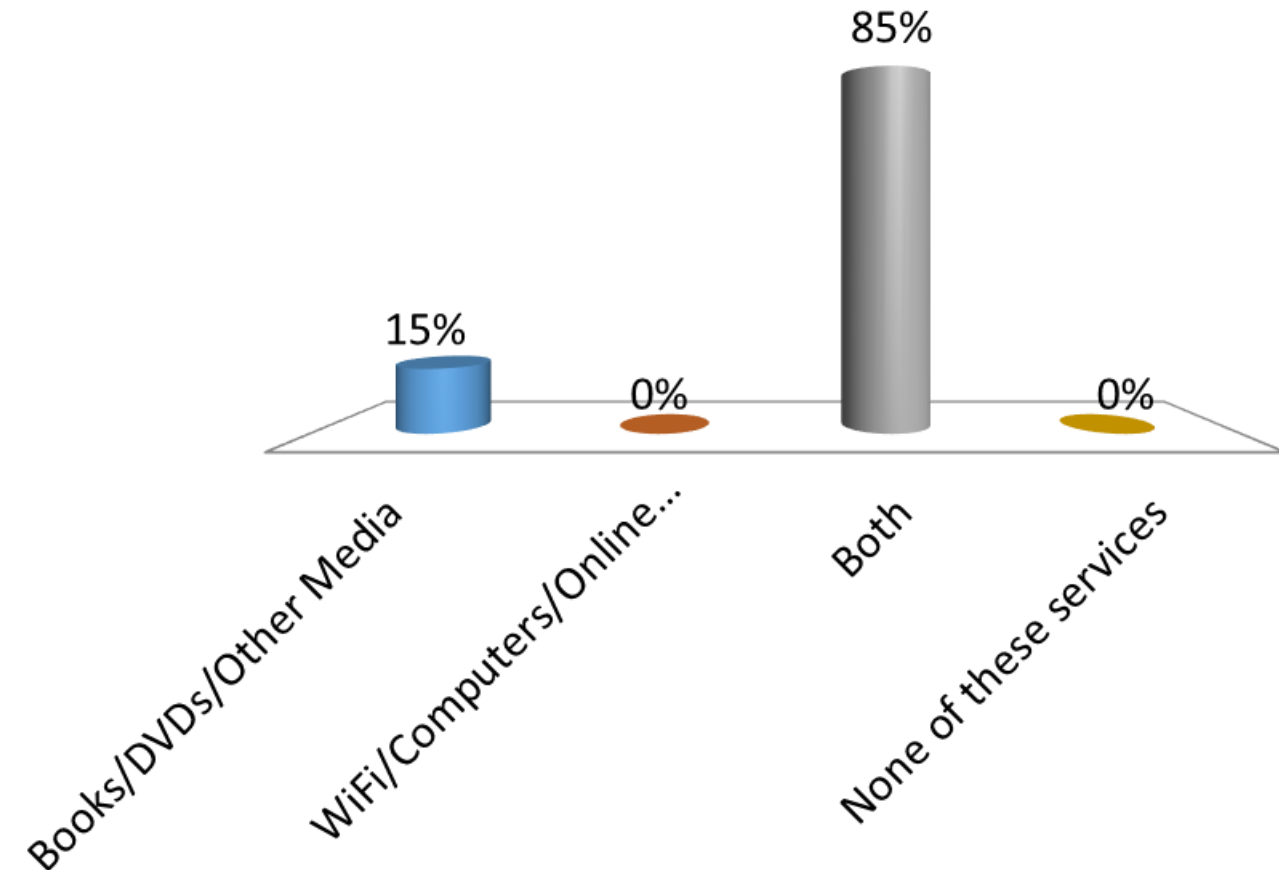

7. What is typically the primary reason for your visit to the library?

- A. Do research/get information/check out books
- B. To volunteer
- C. Attend a class/program
- D. Do homework/tutoring
- E. Use the computer/internet
- F. Be around people/socialize
- G. Reduce stress and relax
- H. Improve skills/education
- I. Use the meeting room

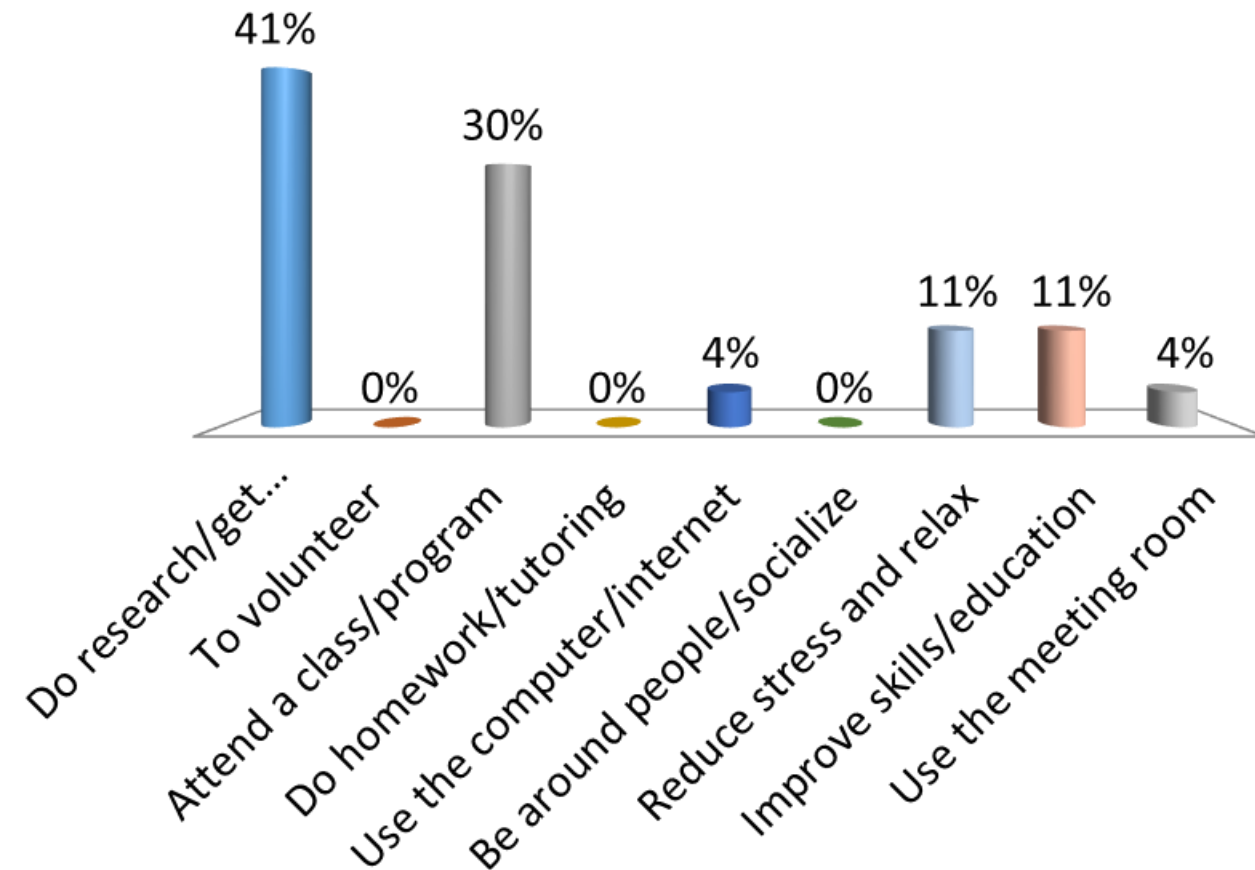

8. What would increase your usage of the Riviera Beach Library?

- A. More/different materials
- B. More/different programs and class offerings
- C. More computers
- D. More meeting/study rooms

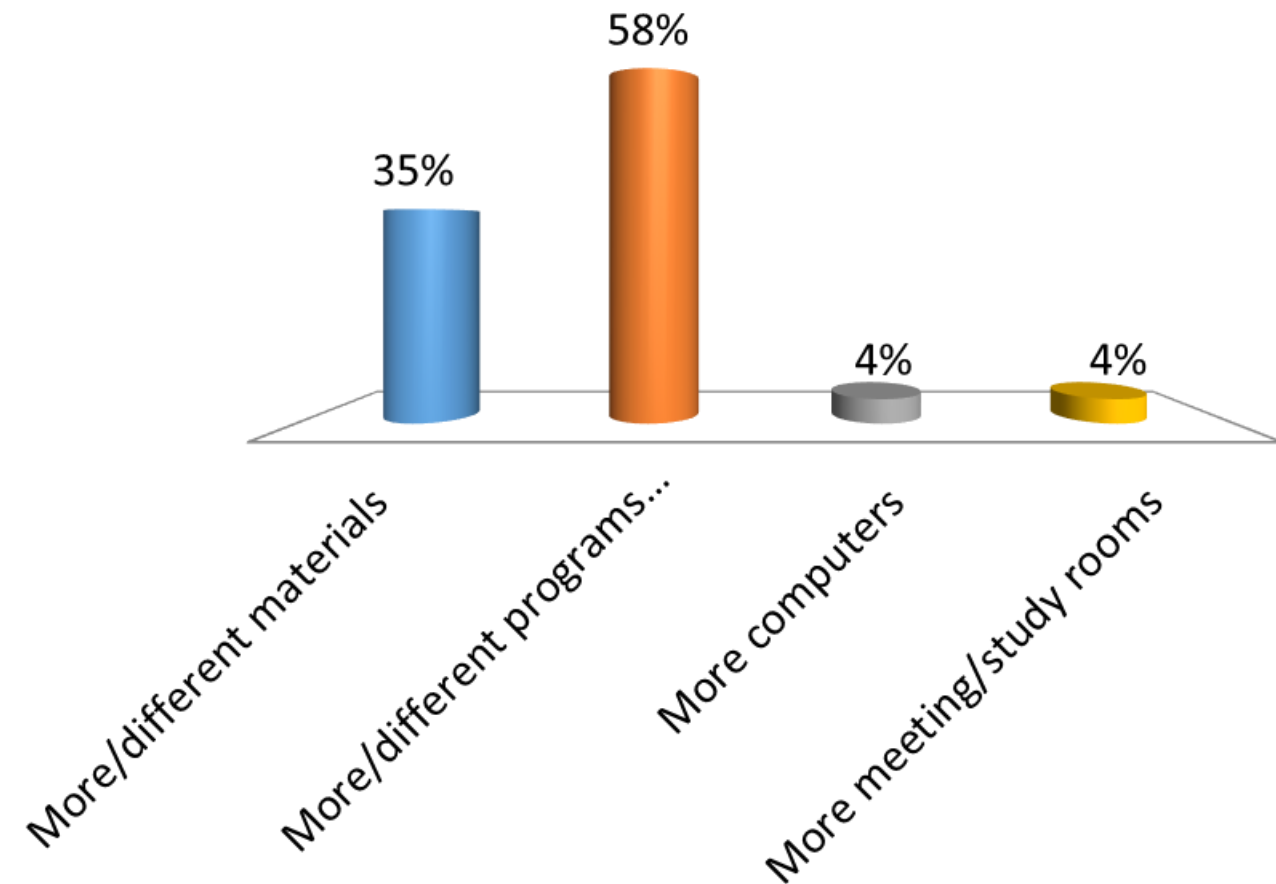

9. What do you think should be the primary role of the library? A place...

- A. To borrow material
- B. To learn/study
- C. To access internet/technology
- D. For community meetings
- E. To socialize

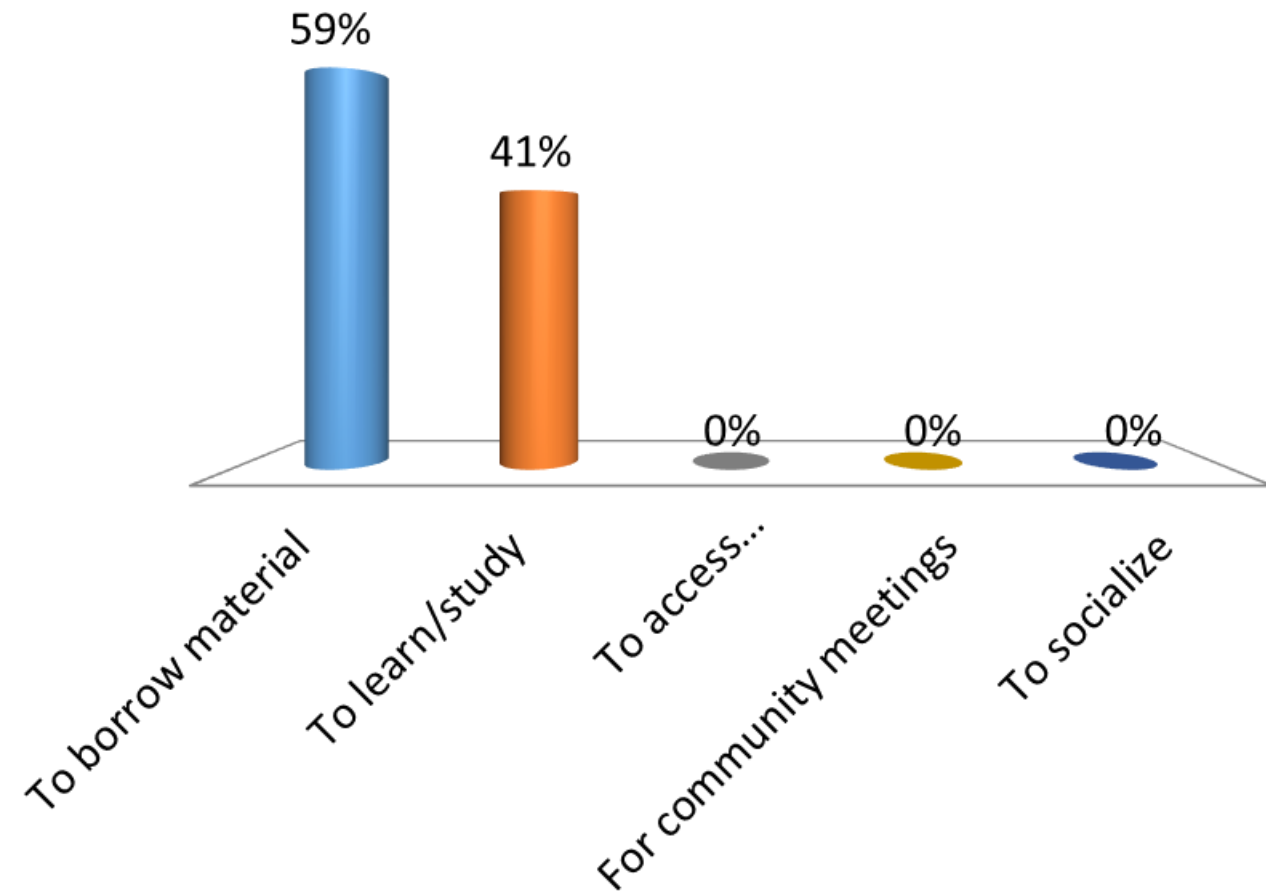

10. Of the following potential features, which would be your favorite to see at the new Riviera Beach Library?

- A. Café (vending type)
- B. Quiet/study rooms
- C. Green/vegetative wall
- D. A fire place
- E. Bubble wall (enclosed waterfall panel)
- F. Outdoor garden/enclosed area

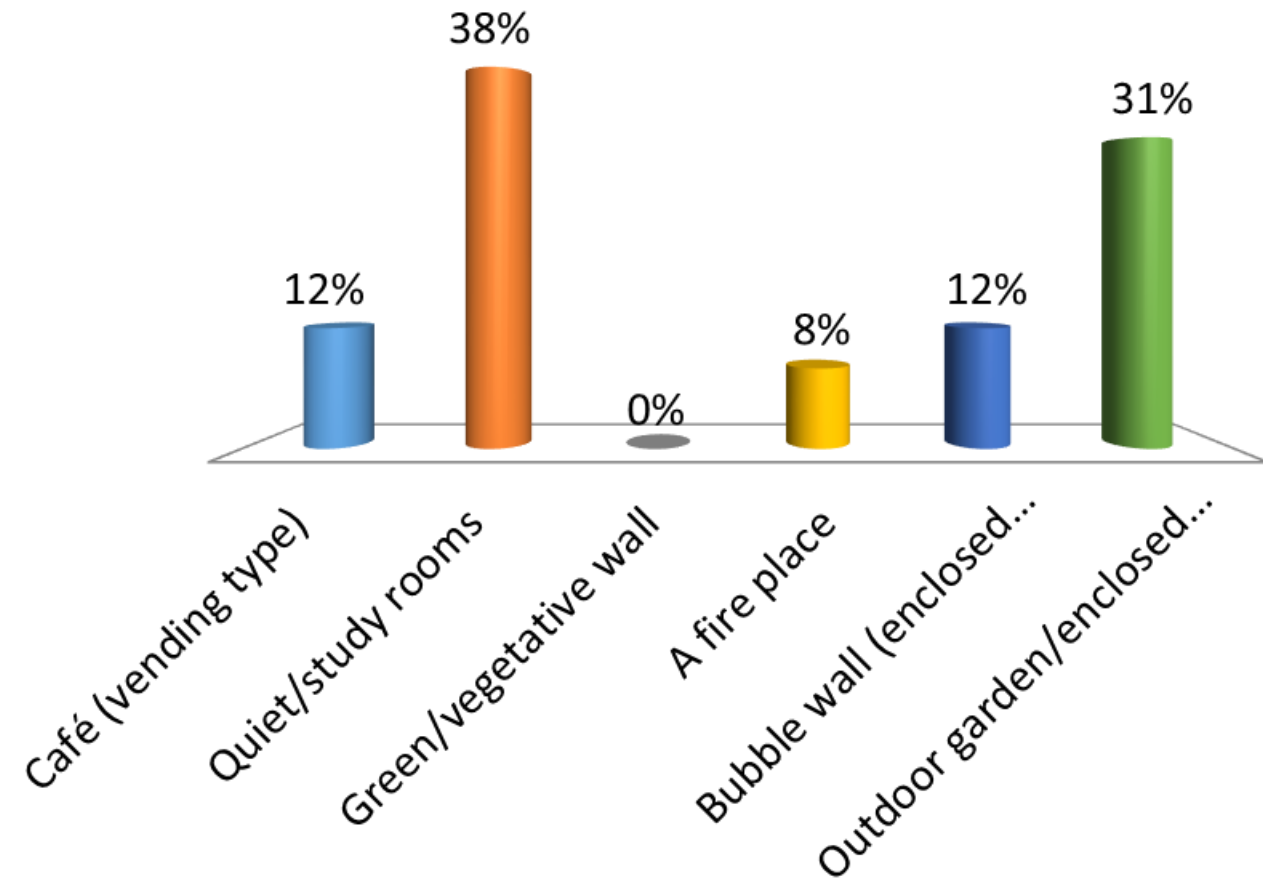

Q & A